



Construction Notice



Early Construction Work for the West Portal VTA's Newhall Yard & Maintenance Facility

Monday, April 22, 2024 – Monday, June 22, 2024

General Working Hours: 6 a.m. – 6 p.m. (Saturday hours as-needed)

What to Expect

- Construction associated with site preparation will commence.
- Fencing and screening around the entire VTA property.
- Construction trucks/vehicles will enter at Newhall St or Brokaw Rd.
- BSVII project construction workers to be onsite starting April 22, 2024.
- There may be vibrations and noise disturbances associated with the site grading.

**Please note that timelines for construction activity have some inherent uncertainty and may change depending on field conditions and/or inclement weather.*

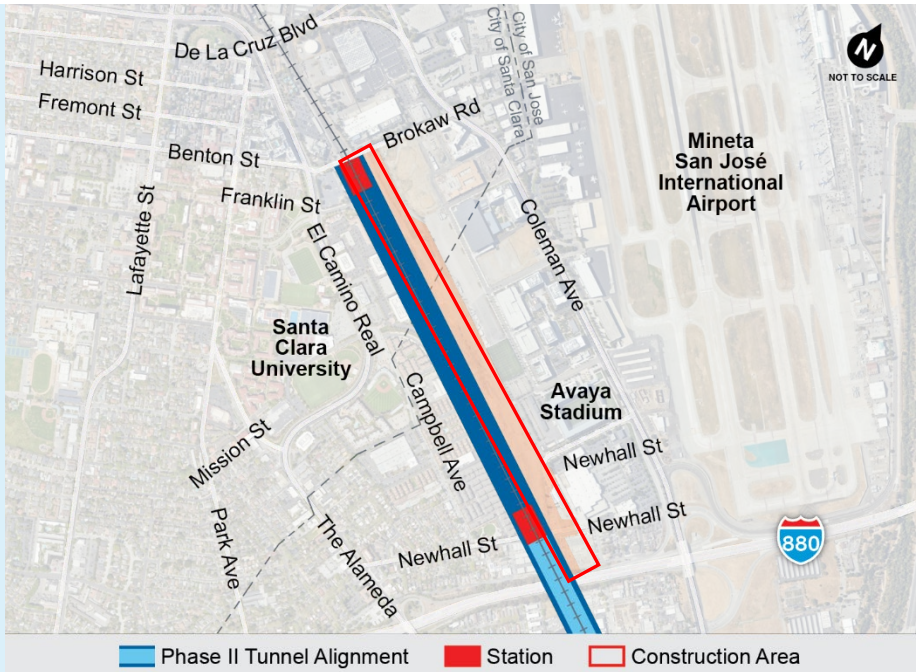

Project Information

VTA's BART Silicon Valley Phase II Extension (Phase II Project) is a six-mile, four-station extension of BART from Berryessa / North San José Station (opened 2020) through downtown San José to the City of Santa Clara. The Phase II Project is planned to include an approx. five-mile subway, three stations with underground platforms (28th Street/ Little Portugal, Downtown San José, and Diridon), one ground-level station (Santa Clara), a train maintenance and storage facility, and additional facilities.

Roadway Safety Tips

- ✓ Maintain a safe following distance
- ✓ Plan your trip ahead
- ✓ Slow down and follow posted speed limits
- ✓ Be aware of your surroundings
- ✓ Pay attention to safety signs

