

BART Silicon Valley Phase II Extension Project

Project and Design Update
Community Meeting

December 2nd and 4th 2024



Agenda

- Welcome & Introduction
- Project Overview & Updates
- Station Designs
- Future Development Around Station Areas
- Construction Updates
- Project Resources
- Next Steps
- Q&A



Project Overview & Updates

Phase I Project – Berryessa Extension



- Two new VTA transit centers with BART stations in Milpitas and Berryessa/North San José
 - Bus transit centers
 - Secure bicycle parking
 - Paid vehicle parking
 - Taxi/TNC/shuttle drop-off/pick-up space
- Opened in 2020



VTA's BART Silicon Valley Phase II Extension



- 6-Mile Extension of BART Service
- 5-mile single-bore tunnel, 1-mile at-grade
- Storage Yard & Maintenance Facility

- 4 New BART Stations
 - 3 street-level entry/underground platforms
 - 1 at-grade level

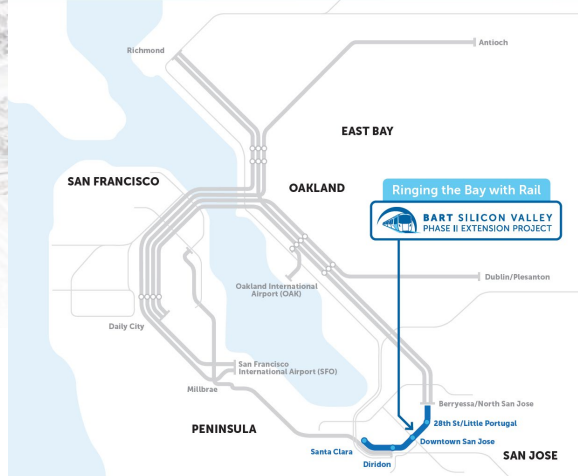

CURRENT as of 12/02/24 – FOR DISCUSSION ONLY

Project Benefits



Providing equitable transit for low-income communities



Connecting 1.7 M transit-dependent riders to resources every year



2 M people in Santa Clara County will gain access to → **3.5 M Bay Area Jobs**



Contribute to an annual **reduction of overall carbon footprint**



Activation of station sites and streets that **foster walkability, vibrancy, activity, and cultivate a sense of community**



Intermodal connection to commuter, intercity, light rail, and regional bus service



5,600 student riders (San Jose State University/Santa Clara University) are projected to use the system daily



Shift dependency on vehicular transportation and **reduce greenhouse gas emissions**

Project Schedule



Based on preliminary schedule for planning purposes.

Project Updates



- West Portal facility groundbreaking ceremony on **Friday, June 14, 2024**
- FTA's New Starts federal funding commitment of **\$5.1 billion** for Phase II announced on **August 2, 2024**
 - Second largest Full Funding Grant Agreement in FTA's Capital Improvement Grant Program history



Progress on Addressing Funding Gap

- Refining Cost Savings
- Exploring non-local funding options for **up to \$100M**:
 - Solutions for Congested Corridors Program (SCCP)
 - SB1 Local Assistance Program

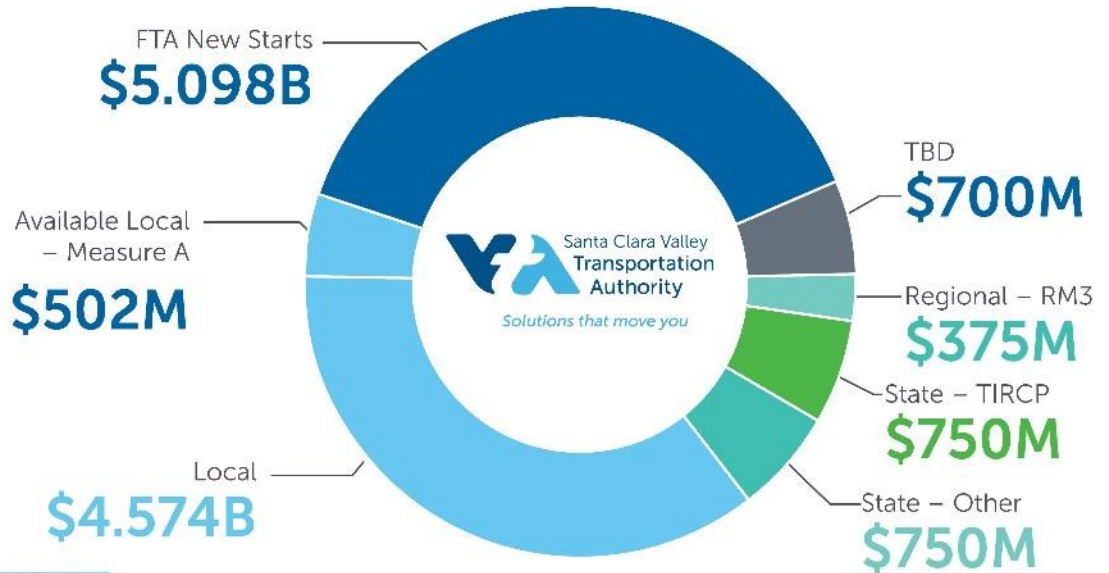

Note: Subject to change pending further analysis.

Path to Federal Transit Administration (FTA) Full Funding Grant Agreement (FFGA)



Prepare for New Starts
Engineering (NSE)
Full Funding Grant
Agreement (FFGA) Submittal
2023-2024 ✓

Submit Cost
Savings to FTA
for FFGA
April 2025

VTA Submits
FFGA Request
Aug. 2025

2023-2024

2025

2026

Refine Station
Design
Now - April 2025

FTA Risk Refresh
Assessment
June 2025

Anticipated FFGA
Dec. 2025 – Jan 2026



Station Design



Passenger Experience



Access and Orientation



Cost



Operations and Maintenance (O&M)



Station Presence



Transit-Oriented Development (TOD) Opportunity & Placemaking



Sustainable Design

Project Alignment



CURRENT as of 12/02/24 – FOR DISCUSSION ONLY

Underground Stations: Typical Layout



- Street-level **station entrance** with faregates, station agent, add-fare machines, etc.
- **Concourse level** below ground spans from station building to underground tunnel
- **Center platform** within the tunnel provides access to trains in both directions

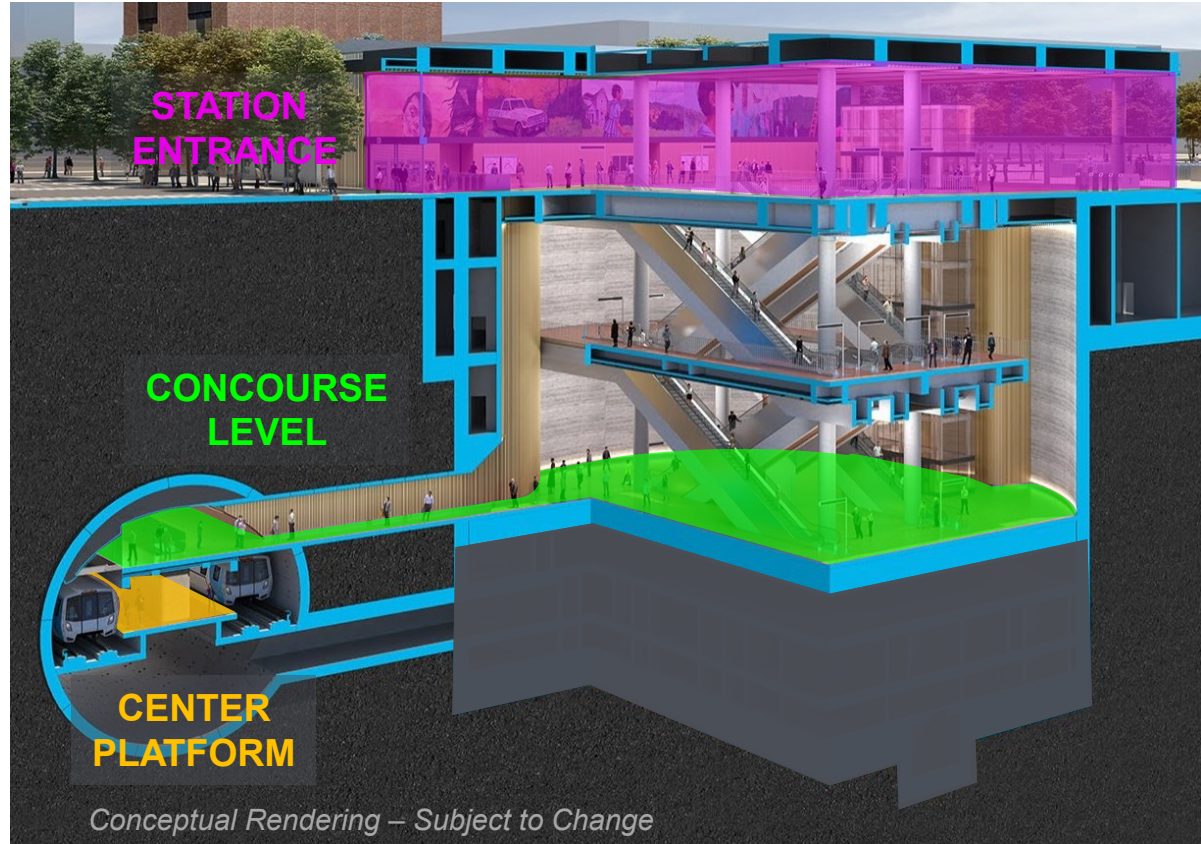

Underground Stations: Typical Circulation



- Faregates at street-level building entrances
- Escalators and stairs to access concourse level.
- High-speed elevators to access concourse level*
- Stairs and elevators* for access between concourse level and platform

**At 28th Street/Little Portugal Station, high-speed elevators will provide direct connection from street-level to platform.*

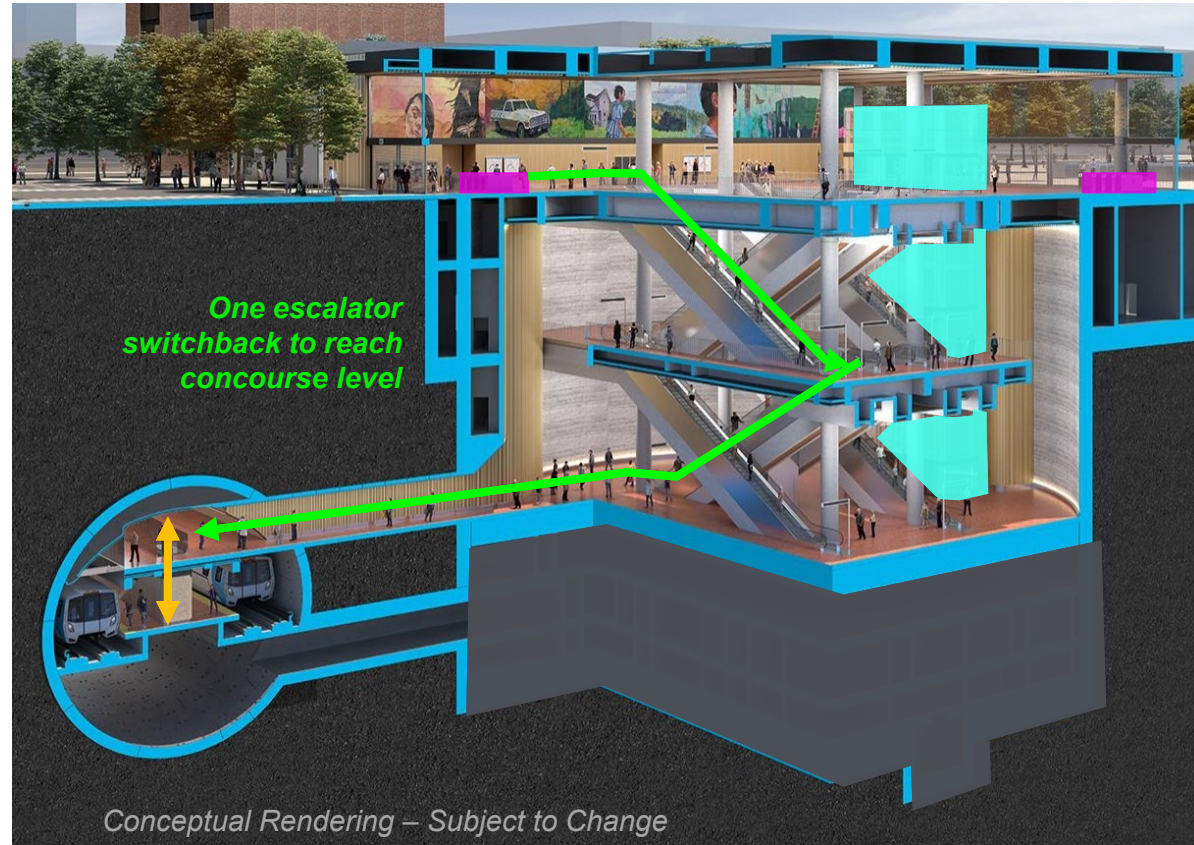

28th Street/Little Portugal BART Station – Opening Day



All site plans are subject to change as project engineering progresses.

28th Street/Little Portugal BART Station – Opening Day



All site plans are subject to change as project engineering progresses.

Downtown San José BART Station – Opening Day

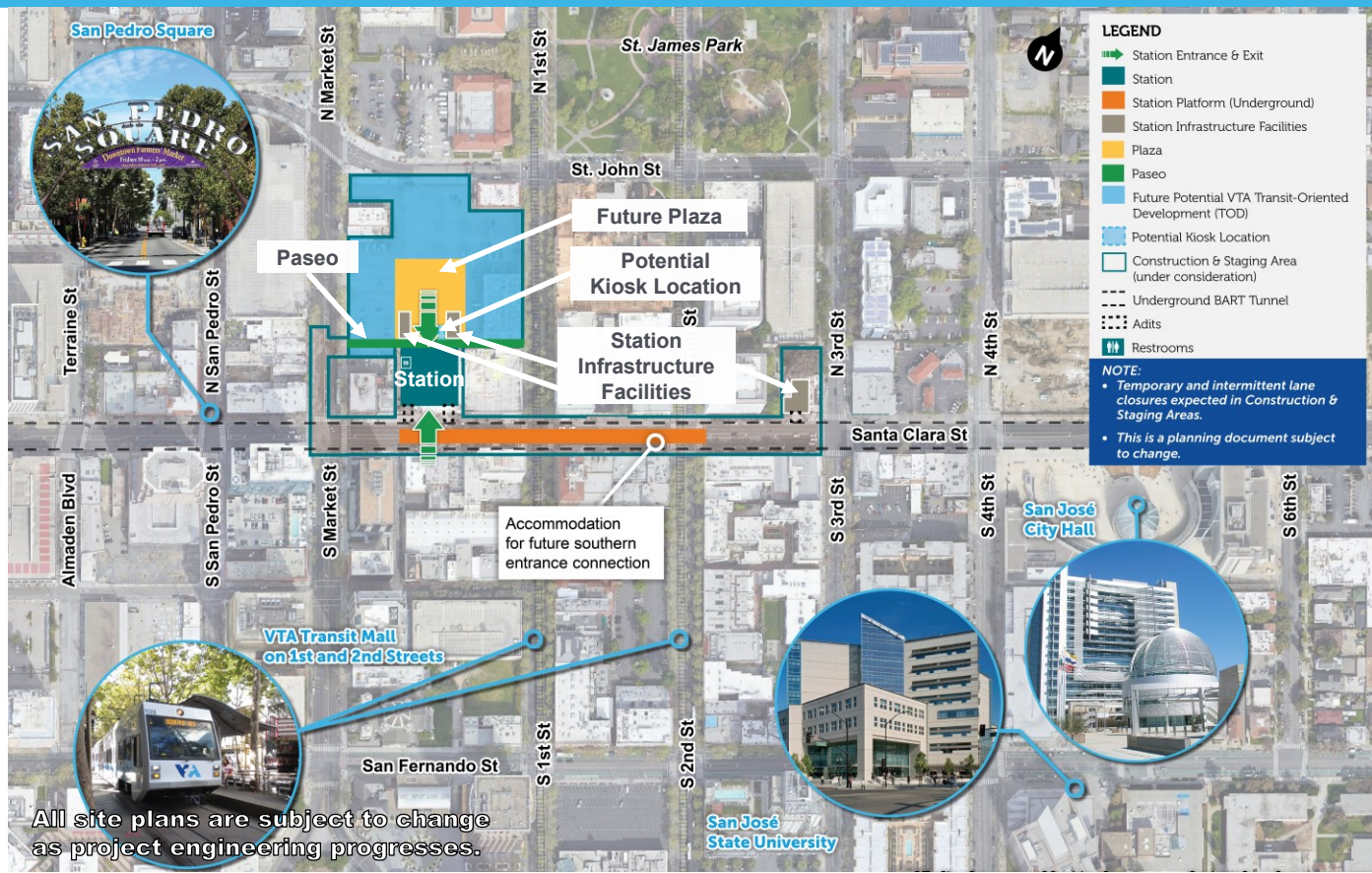

All site plans are subject to change as project engineering progresses.

Downtown San José BART Station – Opening Day



LEGEND

- Station Entrance & Exit
- Station
- Station Platform (Underground)
- Station Infrastructure Facilities
- Plaza
- Paseo
- Future Potential VTA Transit-Oriented Development (TOD)
- Potential Kiosk Location
- Construction & Staging Area (under consideration)
- Underground BART Tunnel
- Adits
- Restrooms

NOTE:

- Temporary and intermittent lane closures expected in Construction & Staging Areas.
- This is a planning document subject to change.



27,900 riders by 2040

Ticketing gates at street level

Bicycle parking

Future Potential Transit-Oriented Development

Santa Clara Street Entrance

Walking distance to historic landmarks & amenities

Connects to VTA Bus/Light Rail

All site plans are subject to change as project engineering progresses.

VTA Transit Mall on 1st and 2nd Streets

Diridon BART Station – Opening Day

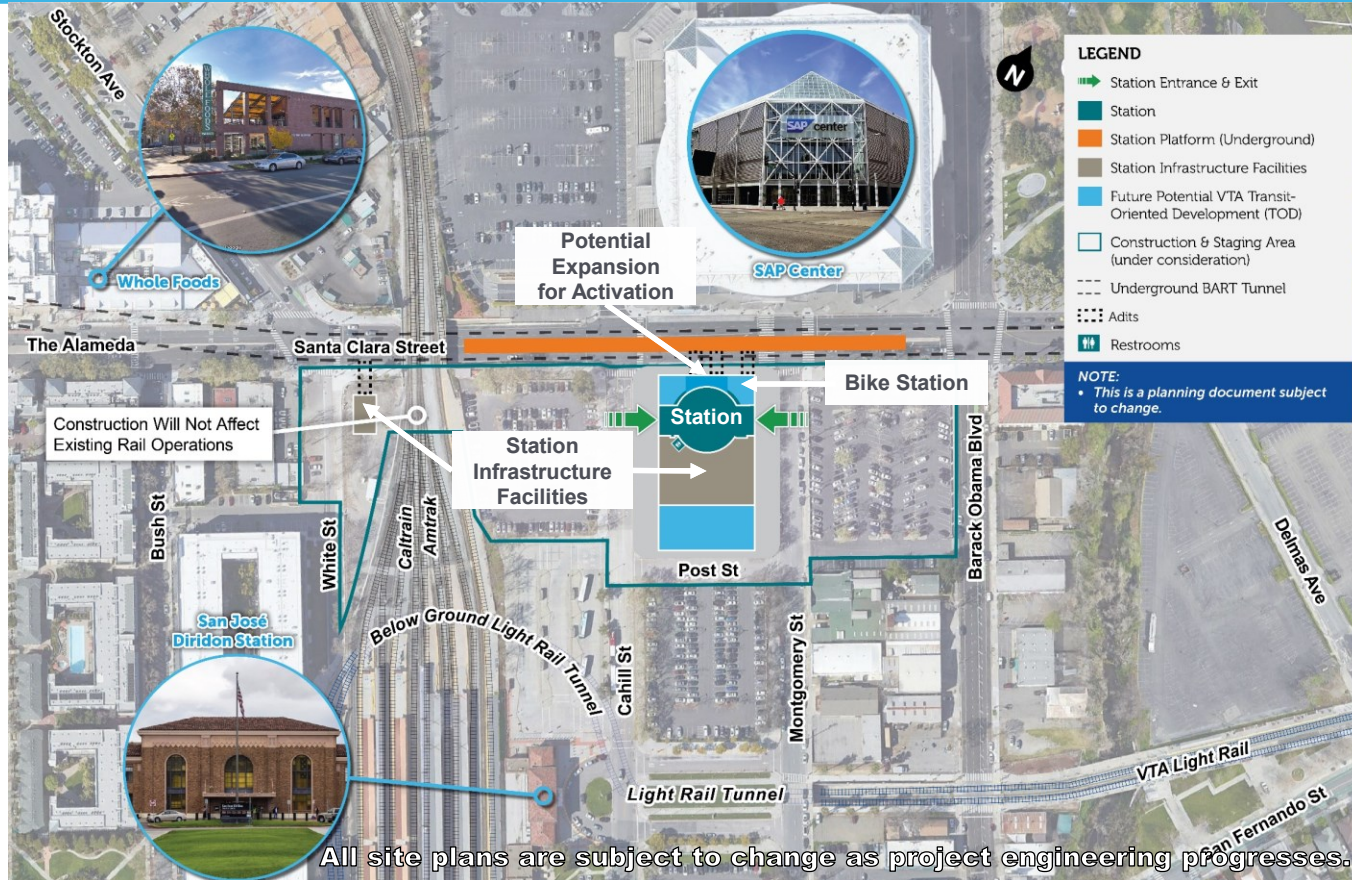

All site plans are subject to change as project engineering progresses.

Diridon BART Station – Opening Day



LEGEND

- Station Entrance & Exit
- Station
- Station Platform (Underground)
- Station Infrastructure Facilities
- Future Potential VTA Transit-Oriented Development (TOD)
- Construction & Staging Area (under consideration)
- Underground BART Tunnel
- Adits
- Restrooms

NOTE:

- This is a planning document subject to change.

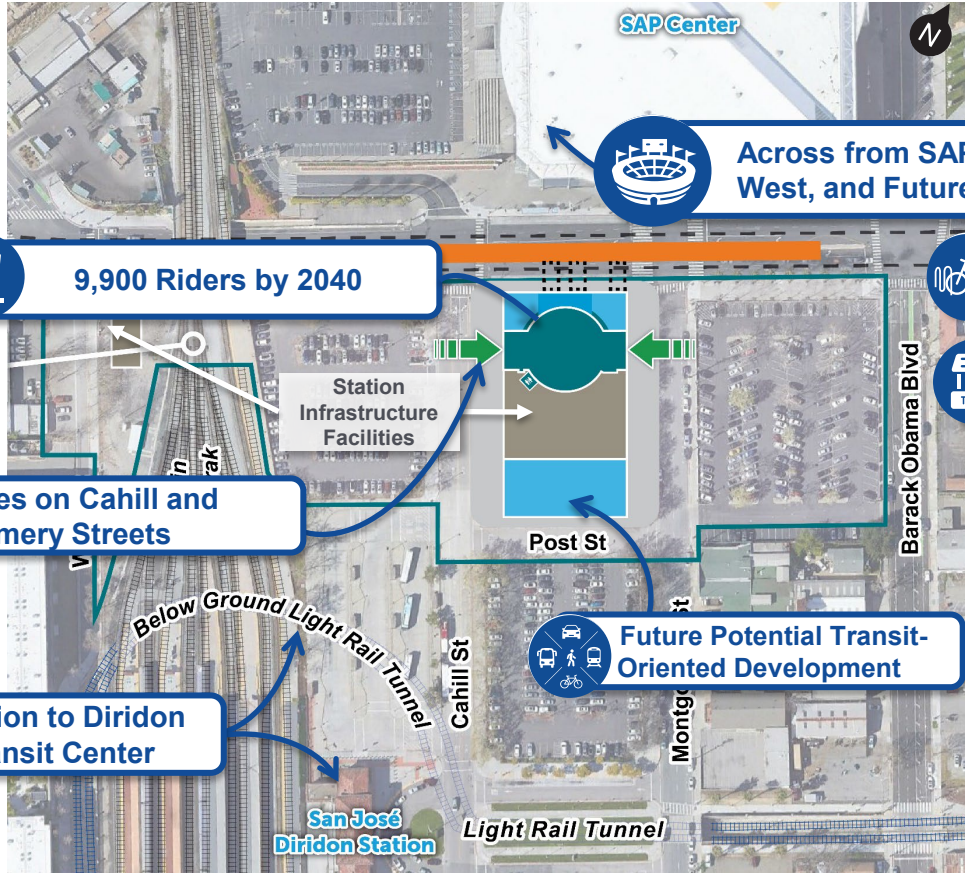

9,900 Riders by 2040

Across from SAP Center, Future Downtown West, and Future Diridon Intermodal Station

Bicycle parking

Ticketing gates at street level

Entrances on Cahill and Montgomery Streets

Future Potential Transit-Oriented Development

Ground Level Connection to Diridon Caltrain Station and Transit Center

Santa Clara BART Station – Opening Day

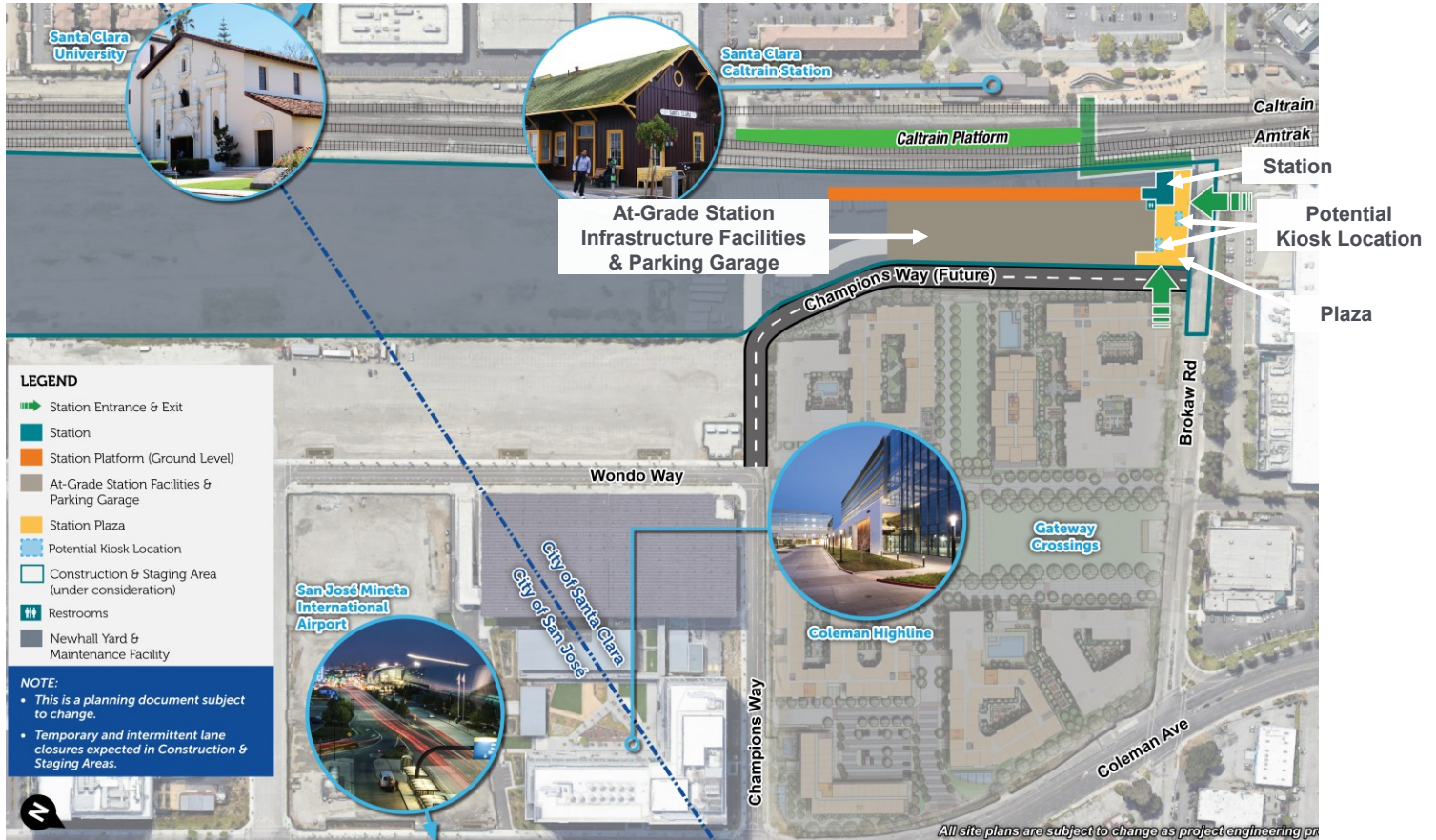

All site plans are subject to change as project engineering pr

Santa Clara BART Station – Opening Day

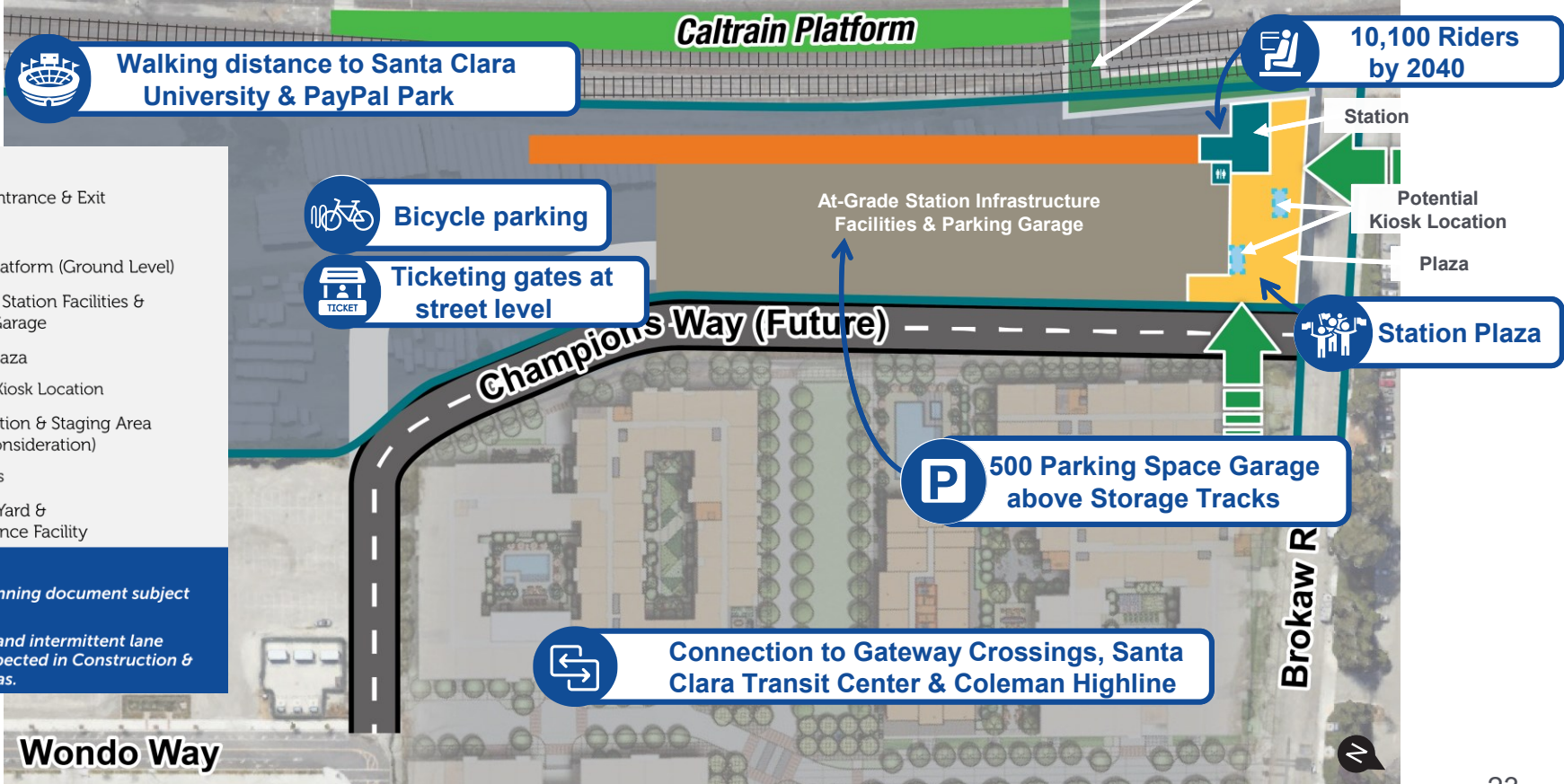

LEGEND

- Station Entrance & Exit
- Station
- Station Platform (Ground Level)
- At-Grade Station Facilities & Parking Garage
- Station Plaza
- Potential Kiosk Location
- Construction & Staging Area (under consideration)
- Restrooms
- Newhall Yard & Maintenance Facility

NOTE:

- This is a planning document subject to change.
- Temporary and intermittent lane closures expected in Construction & Staging Areas.



Future Development Around Station Areas

Potential Development Opportunities



The entire corridor has the potential for approximately
+40,000 new jobs and +80,000 residents

SANTA CLARA STATION AREA

New Development:
12.7 Million sq. ft.

DIRIDON STATION AREA

New Development:
15 Million sq. ft.

DOWNTOWN SAN JOSÉ STATION AREA

New Development:
23.8 Million sq. ft.

28TH STREET / LITTLE PORTUGAL STATION AREA

New Development:
8.5 Million sq. ft.

VTA's TOC Vision

www.vta.org/TOC

Connecting housing, jobs, learning, recreation, shopping, and daily activities without needing to drive

Focusing growth along current and future transit corridors and stations:

- ↑↑ Ridership & access to opportunity
- ↓↓ Greenhouse gases (GHG)
- ↓↓ Vehicle miles traveled (VMT)

Tools: Interagency and public-private partnerships for transit-oriented developments (TOD) + grants to CBOs

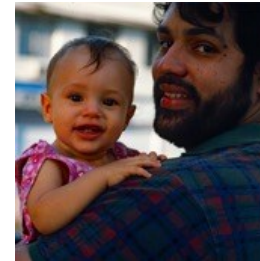
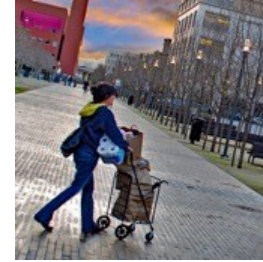

Current Planning Efforts: Developer Guidelines at 28th Street/Little Portugal

Culture + Community

Art & Culture



Open Space



Active Uses



Urban Fabric + Environment

Block Structure

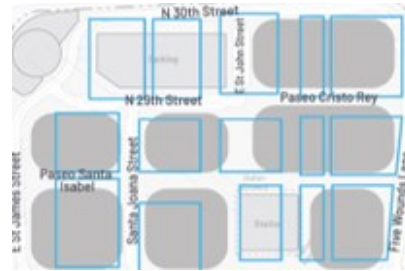

Land Use



Buildings



Mobility + Connectivity

Active Mobility Network



Transit Network



Internal Vehicular Network



VTA's Transit-Oriented Communities (TOC) Grants in 2025

\$750,000 to advance *equitable* mixed-use, mixed-income communities next to transit



Planning & Policy Implementation

Implement plans, policies, and regulations to advance equitable communities next to transit



Community Resilience

Strengthening small business resiliency or ability to advance preservation or production of affordable housing.



Education & Engagement

Community support and advocacy for Transit-Oriented Communities projects, through equitable engagement.



Placemaking, Arts, & Activation

Placemaking to create accessible and welcoming public spaces reflecting the vibrancy of the local history, culture, and identity.

VTA's Current Planning Efforts: Access Studies

28th Street/Little Portugal Station Area

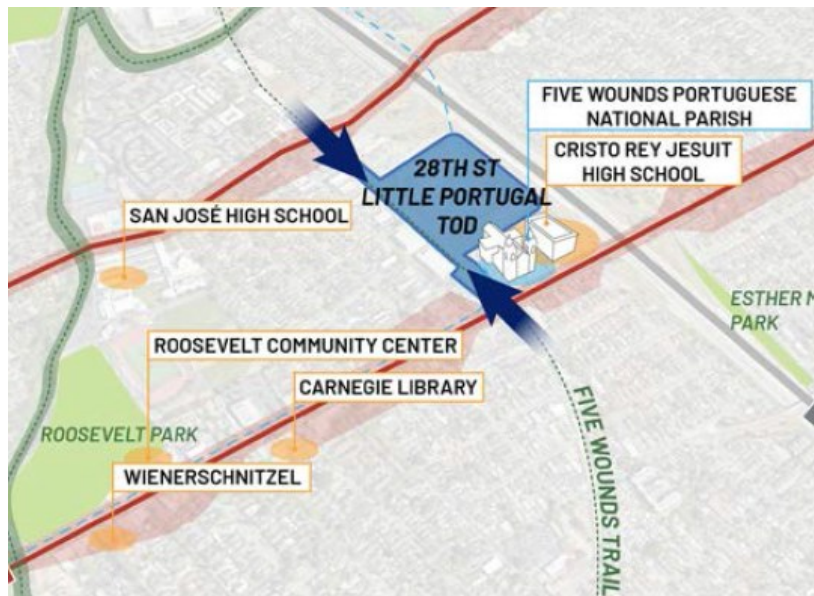

Source: Design Development Framework, 2024

Downtown San Jose Station Area

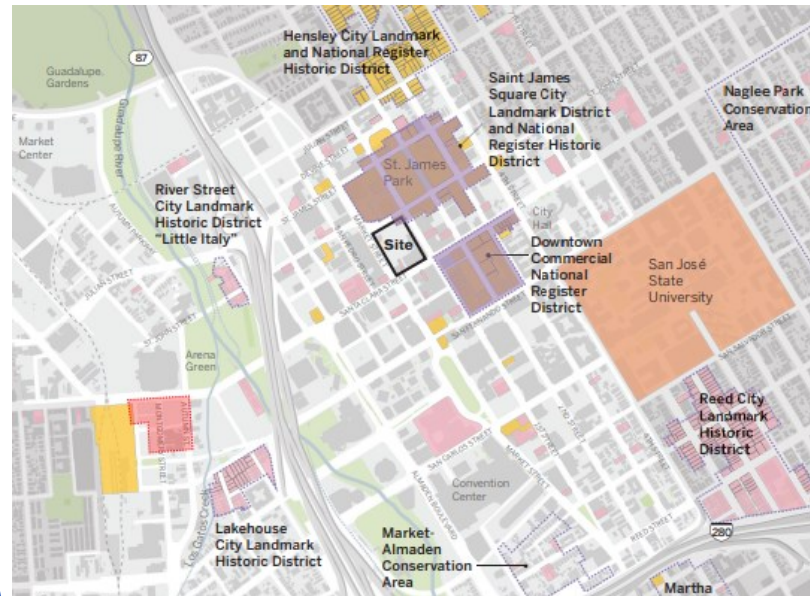

Source: Design Development Framework, 2021

Get Involved in the Access Study!



Participate in the access study surveys online:



vta.org/downtownSJ.survey



vta.org/28LP.survey





Construction Updates

Construction Activities

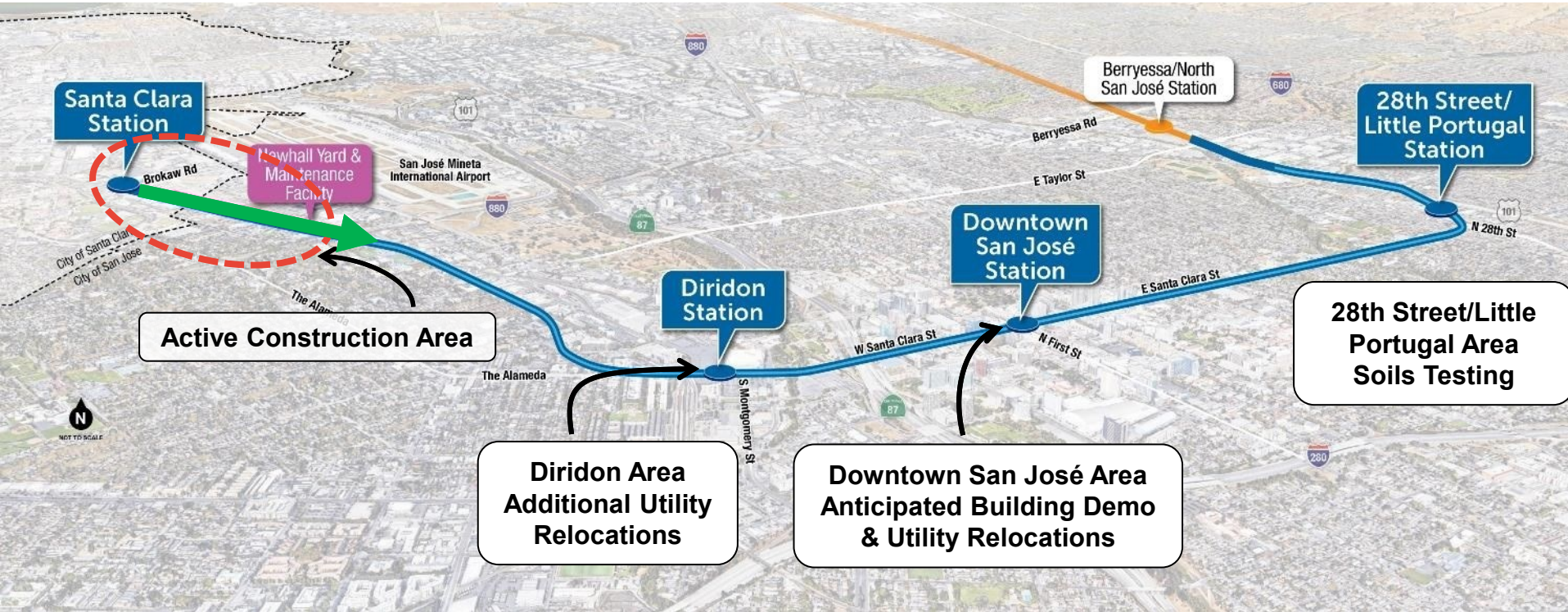

West Portal Site Flyover



CURRENT as of 12/02/24 – FOR DISCUSSION ONLY

Project Screening and Signage



Project screening and signage provided around construction areas.



BUSINESSES OPEN DURING CONSTRUCTION

OnPoint Camera • Limitless Accounting • Café Mocha
Fitness Center • Food Creation • Sandwich Spot

EAT SHOP LOCAL

Shop Local Marketing is a VTA-sponsored campaign that provides small businesses media and marketing assistance during major construction of VTA's BSVII Project. Scan the QR code to see how you can support local!

#EatShopLocalBSV

VTA logo and 'We're the transportation authority' tagline.

Thriving Business Program Sign

BART SILICON VALLEY PHASE II EXTENSION PROJECT

Future **Santa Clara Station**
Newhall Yard & Maintenance Facility

Construction Information QR code

Your new partner at work: AECOM, VTA, Caltrans, Regional Measure 3, Federal Transit Administration

(408) 321-2345 VTABART.org

Project Information Sign

Construction Outreach



Coordinate with cities and developers on ongoing and upcoming adjacent construction projects



Coordinate with Cities on wayfinding, messaging, street closures, and detours



Monitor that all construction parking is within the construction staging areas



Communicate information from Engineering and Environmental Teams on upcoming construction



Construction Notices

- *Physical door knocking & flyering*
- *Online alerts & website updates*



Resources

- *Interactive Live Construction Map*
- *Sign up for construction activity notices at www.vta.org/bsv2updates*

Thriving Business Program Elements



Eat Shop Local

BUSINESSES OPEN DURING CONSTRUCTION

OnPoint Camera • Limitless Accounting • Café Mocha
Fitness Center • Food Creation • Sandwich Spot

Shop Local Marketing is a VTA sponsored program that provides business media and marketing assistance during the BSM Phase II construction. Make sure to check out the Preferred Vendor List to see how you can support local!

EAT SHOP LOCAL

EL NOPAL • EL MÚSICO • EL MUNDO • EL MELON
EL GUACAMOLE • EL GORRO • EL GALLO • EL EMOJI

EAT SHOP LOCAL

Source: Valley Metro Deals and Discounts



Source: SCORE Business mentorship and training

Local Resource Network



Source: Valley Metro South Central Community Office



Source: LA METRO Small Business Report Highlight

Direct Financial Assistance



Project Resources

Project Website



VTABART.ORG

CURRENT as of 12/02/24 – FOR DISCUSSION ONLY

Public Engagement



Interactive Efforts



Tabling events throughout the year around the station areas



Community Working Group meetings



Public Meetings



Community Group Meeting Outreach

- Reach out to have us present updates at your local Community Group/Neighborhood Association/etc. www.vta.org/about/subscribe

Resources



Project Hotline Number: **408-321-2345**

- Call to learn more about specific project efforts and provide your feedback



Project Website: **vtabart.org**

Sign up to get alerted on nearby construction and find Informational Factsheets, Newsletters, and Blog Posts



Email questions to: **vtabart@vtabsv.com**

Social Media



Twitter: **[@vtabsv2](https://twitter.com/vtabsv2)**

Facebook: **[@vtabsv](https://www.facebook.com/vtabsv)**

Instagram: **[@vtabsv2](https://www.instagram.com/vtabsv2)**



Next Steps

Upcoming Activities in 2025!



Downtown San José
Field Office Opening
Winter 2025



West Portal/TBM Launch
Structure Construction
Anticipated **Winter 2025**

Stations Look and Feel
Community Engagement
Summer/Fall 2025



**Subject to change*

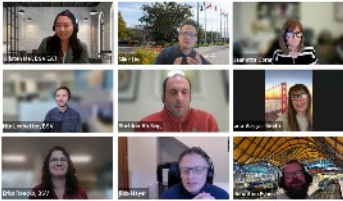

Stakeholder Engagement on
Design & Aesthetics
Spring 2025

Thriving Business Program
Summer 2025



Reoccurring Events

- Monthly Meetings and Activities**
 - VTA Board of Directors Meetings
 - VTA BSVII Oversight Committee Meetings
 - Tabling Events
- Quarterly Community Working Group (CWG) Meetings**



Discussion



Station 1:

Project Overview

Station 2:

BART Station Designs

Station 3:

Construction Update

Station 4:

Transit Oriented Development &
Communities

Station 5:

Access Study – TAKE THE SURVEY!

Estación 1:

Descripción del Proyecto

Estación 2:

Diseños de la BART Estación

Estación 3:

Actualización de la Construcción

Estación 4:

Desarrollo Orientado al Tránsito y Comunidades

Estación 5:

Estudio de Acceso – ¡RESPONDE LA
ENCUESTA!